

3,700 Retail/Restaurant Space Available

SPACE AVAILABLE
ONE BLOCK FROM
VERIZON CENTER

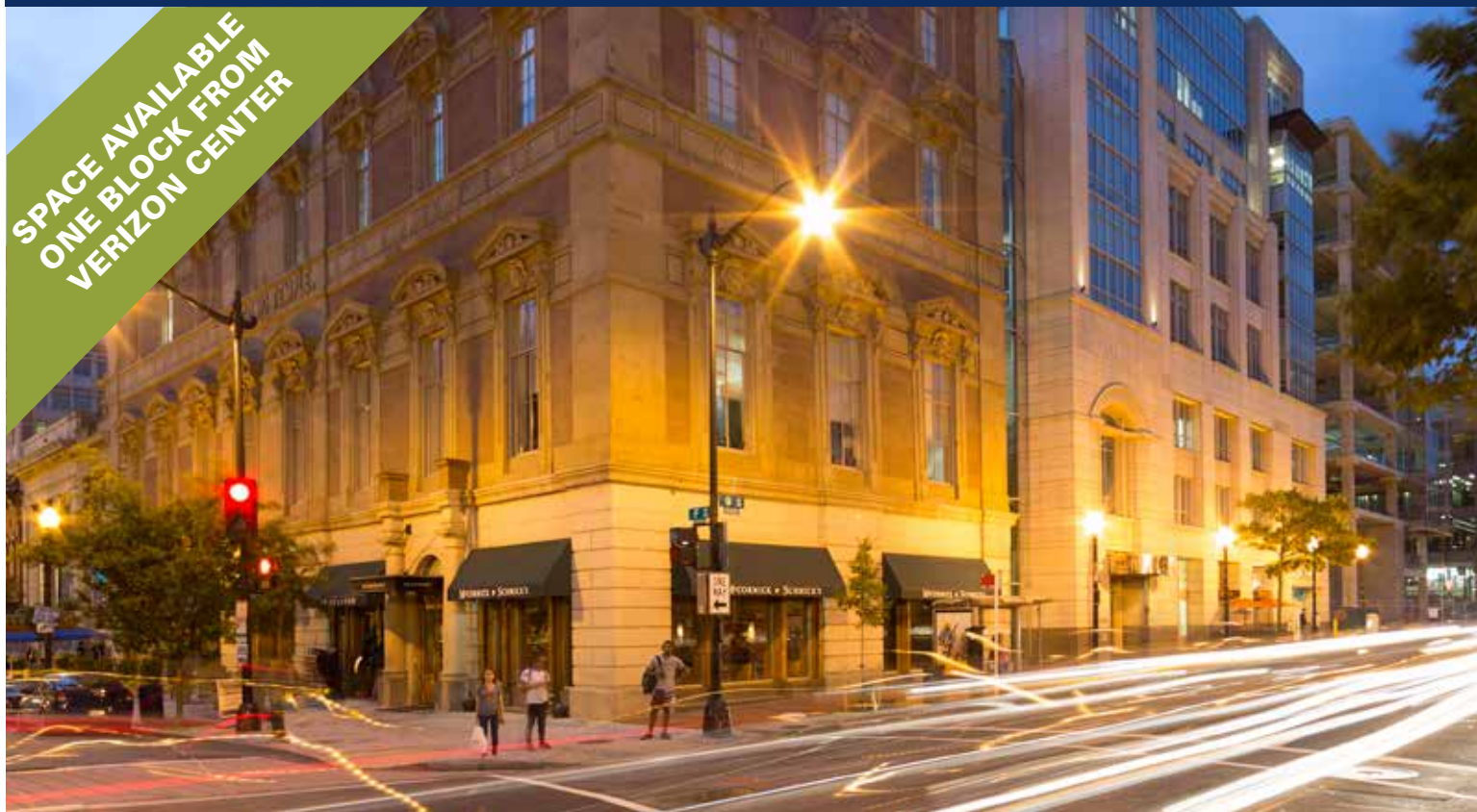

STATISTICAL SNAPSHOT .25-MILE RADIUS, 2013 DEMOS



POPULATION
1,382

AVG HH INCOME
\$173,437



TRAFFIC COUNTS
16,700 VPD
(9TH STREET)
7,800 VPD
(F STREET)



DAYTIME POPULATION
38,589



AREA ATTRACTIONS

**American Art Museum, The
Verizon Center, International
Spy Museum, Crime Museum,
Madame Tussaud's**

CONTACT:

Bill Dickinson
bdickinson@rappaportco.com
(T) 703.310.6983

Melissa Webb
mwebb@rappaportco.com
(T) 571.382.1227

Michael Howard
mhoward@rappaportco.com
(T) 571.382.1219

901 F STREET, NW FACTS AT-A-GLANCE

- Located at the corner of F Street and 9th Street with 7,800 vehicles passing each day
- Located one block from the Verizon Center where 220 events are held yearly
- Great restaurant and fashion co-tenancy in neighborhood
- 1,534 new residential units delivered in 2014 within a half mile with more on the way
- Second generation restaurant space in beautiful historic building
- Located in Washington's most vibrant Live, Work & Play neighborhood

DEMOGRAPHICS (2013)	.25 MILE	.5 MILE	1 MILE
POPULATION	1,382	7,593	39,172
AVG HH INCOME	\$173,437	\$123,724	\$98,298
EMPLOYEES	38,589	98,888	234,150
SITE FACTS			

SPACE: 2,926 SF Available

TRAFFIC COUNTS: 16,700 VPD on 9th Street & 7,800 VPD on F Street

3,700 Retail/Restaurant Space Available

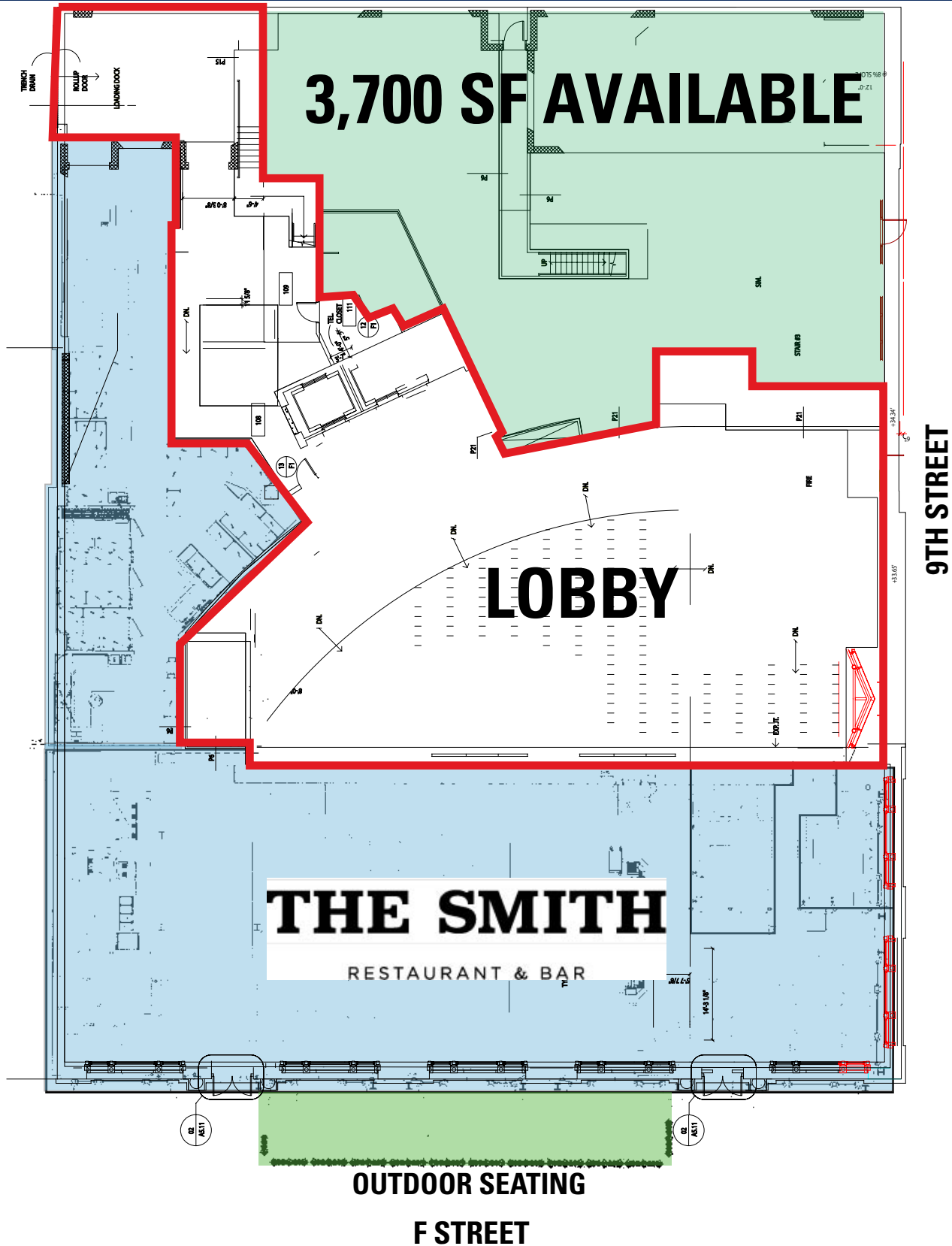

RAPPAPORT

901 F STREET, NW
Washington, DC

2,926 Retail/Restaurant Space Available

